

This drawing is copyright.
 Contractors must check all dimensions on site. Only figured dimensions to be worked from and discrepancies to be reported immediately to the Architect before proceeding.
 This drawing is for location purposes only and does not constitute an accurate site survey

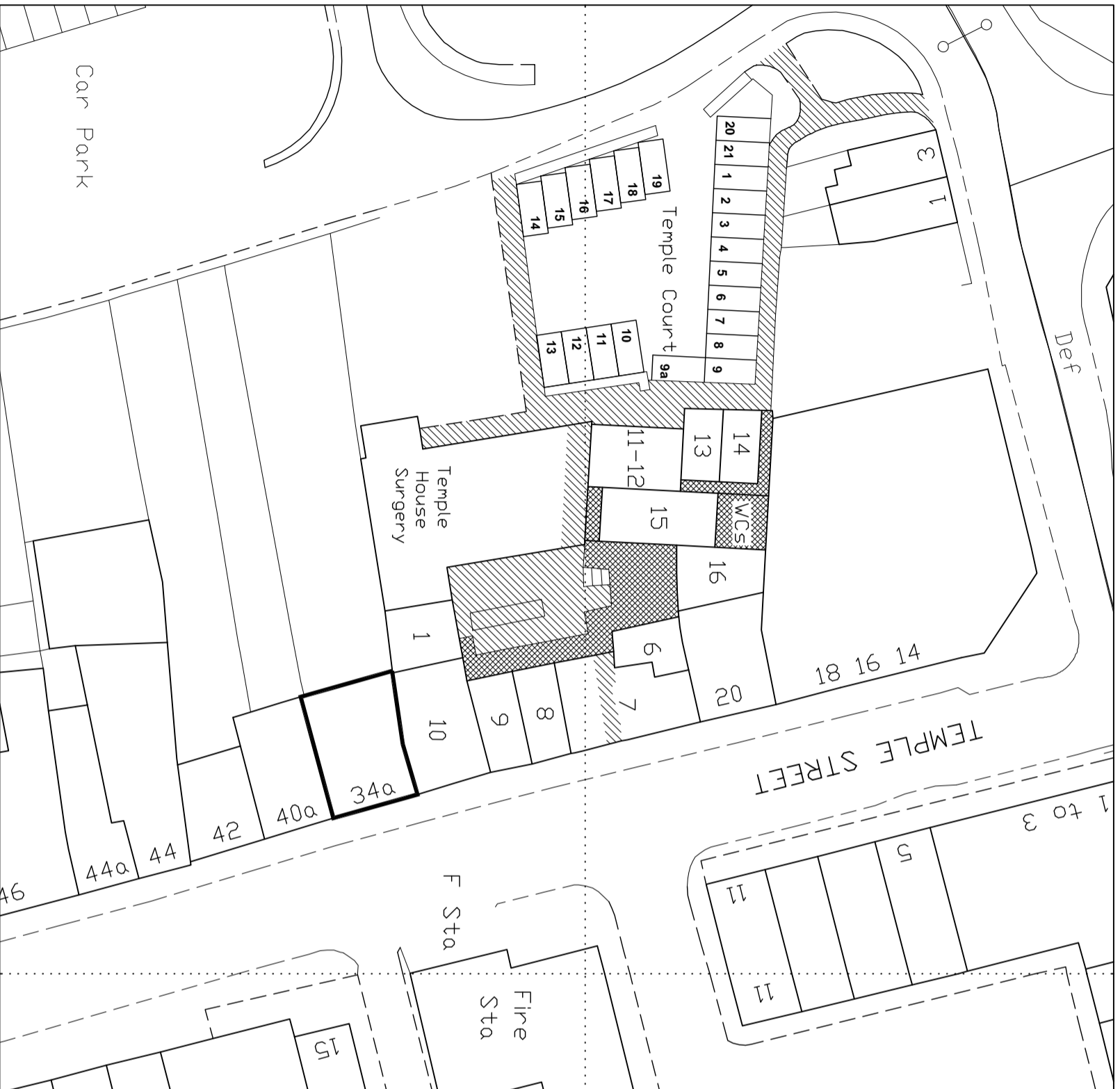

FIRST FLOOR UNIT LOCATION PLAN

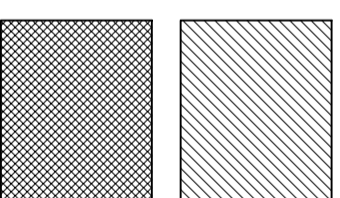

COMMON AREAS AND WALKWAYS - GROUND FLOOR

COMMON AREAS AND WALKWAYS - FIRST FLOOR

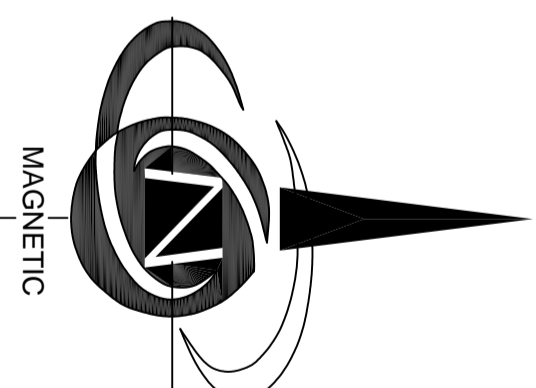

MAGNETIC

Revision	Details of revision	Date

N+S Stray Architectural Technician 22 Egerton Road, Bath BA2 2DP tel/fax : 01225 338437 email : nigel@spraggs22.freeserve.co.uk	
Client:	John H. Paget
Job Title:	Temple Court Keynsham Bristol
Drawing Title:	Location Plan for No. 34a Temple Street, Keynsham
Scale:	1:500
Date:	June 2006
Drawn by	N.S.
Job No.:	
Drawing Ref. No.:	
Rev	
Loc	34a